

AutoSig® Smart Filter System

Fuel Filter - Water Separator - Integral Water Probe

The AutoSig® SMART Filter System is an integrated system for the marine industry combining a fuel filter, water separator and integral water in fuel sensor.

It senses water in the fuel separator (Diesel or gas) before the water can enter the engine. Water in the engine fuel system can cause engine damage, hard starting, loss of power, misfiring, or stalling.

The AutoSig® SMART Filter System is designed to pass UL 1105, ABYC and US Coast Guard fuel system requirements.

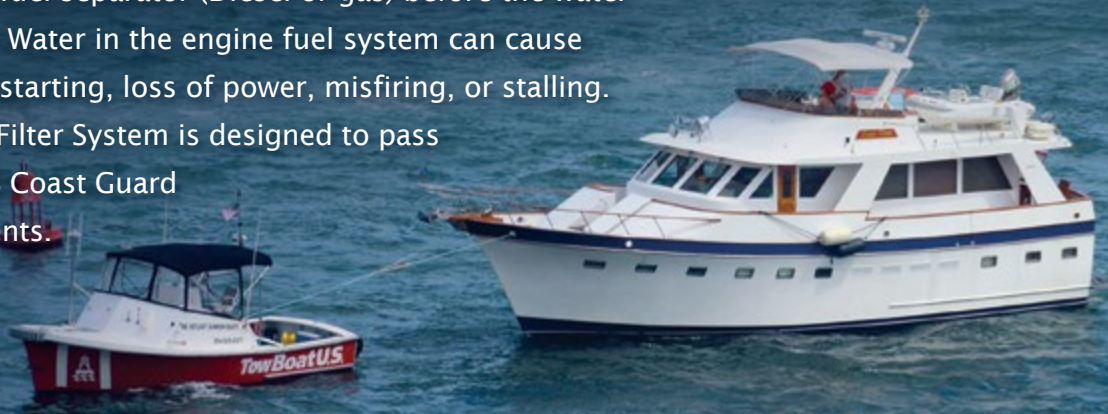

The Entratech AutoSig® System utilizes a innovative concept (US patents pending) that places the water probe INSIDE the filter housing. AutoSig® is engineered for the marine industry with a disposable spin on filter that can be easily replaced while the sensor electronics stay mounted in the filter head. Entratech AutoSig® SMART Fuel Filters can communicate directly with ECM's and instrument panel indicators. The versatile AutoSig® SMART Filter System can be configured for networking, Wi-Fi and other communication standards.



- **Self-contained sensor**, no external probes to change, reduced fuel spillage
- **No probes to cross thread** when changing filters
- **Designed to pass UL 1105 ABYC and US Coast Guard** fuel system requirements
- **Self-testing circuit** (Standalone units available)
- **Direct drop in replacement** for common engine ECM formats
- **Wireless capability & CAN Bus** coming soon

Cost Savings with AutoSig® technology.



The AutoSig® SMART Filter System with built-in probe sensor eliminates expense and assembly of an external sensor. The AutoSig® is available with industry standard connectors as well as a wireless option.

AutoSig® is available in 3 separator lengths for extended filter life.



Entratech Systems manufactures units based on filter media type and can size. The AutoSig® system is available in 3 different fuel filter separators sizes for gasoline or diesel. Price is comparable to most fuel filter separators, with the added advantage of an integral water probe. AutoSig® provides safety, improved reliability, ease of replacement, and reduced cost.

AutoSig® standard specifications.

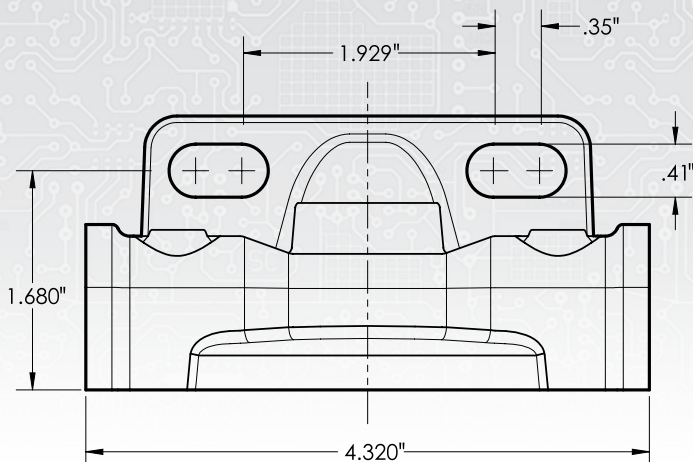

- Materials:** Cast bracket available in 356-T6 aluminum or 316 annealed stainless steel
- Connectors:** Industry standard connectors
- Mounting:** Industry Standard mounting holes
- Filter size:** Standard can diameter, +2" and +4" lengths.
- Can:** Utilizes standard 1-12 inch spud thread size

AutoSig Data Sheet: MarineES09022015